



PTM 200

6,5PK BENZINEMOTOR MET HORIZONTALE AS

PTM 200

CE

EU2

EPA

CARB

ACHTERKANT



ONDERKANT



LINKERKANT



RECHTERKANT



PRESTATIE CURVE

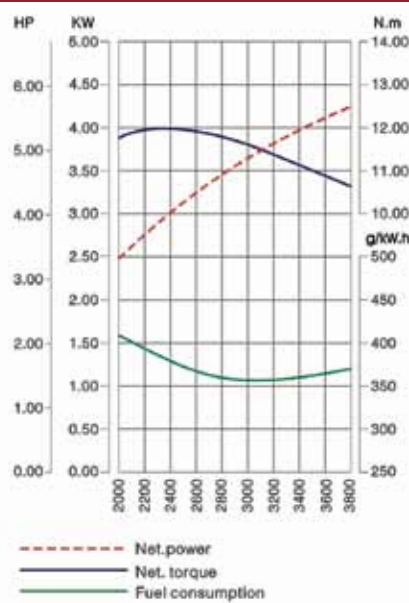

TECHNISCHE SPECIFICATIES

Motor type	1 Cilinder, 4-takt, OHV, geforceerde luchtcooling
Max. vermogen	6,5PK(4,8kW)/3600rpm
Net. Koppel	12,5Nm/2500rpm
Compressie ratio	8,5 : 1
Boring x Slag	68 x 54 mm
Cilinderinhoud	196 cm ³
Draairichting	Linksom (tegen de klok in)
Ontsteking	TCI
Tankinhoud	3,6 liter
Drooggewicht	16 kg
Motorolie capaciteit	0,6 liter
Afmetingen(LxBxH)	376 x 312 x 335 mm
Startsysteem	Recoil (E-start optioneel)
Geluid	70 dBA
Stationair toerental	1450 rpm (±150rpm)

20 MM AS

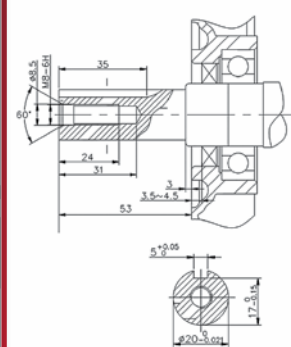

19,05 MM AS

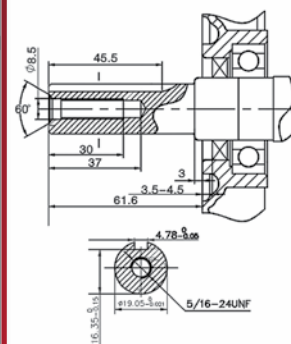

MOTOR

