

Parts and Hardware List

Part	Description	Quantity
1	Hopper	1
1-1	Control Cable	1
2	wheel	2
3	Spinner Disc	1
3-1	Gear Case Assembly	1
4	Steering Link Connector	2
5	Back Hopper Support	2
6	Right Hopper Support	1
7	Left Hopper Support	1
8	Split Bushing	2
9	Front Bracket	1
10	Axle	1
11	Cotter Pin	1
12	Screw M6x35	1
14	Screw M6x50	5
15	Large Flat Washer	1
16	Small Flat Washer	15
17	Lock Washer	2
18	Hey Nut M6	14
19	Screw M6x55	1
20	Release pin	1
21	Screw M6x40	8
22	Cable lock nut	1
23	Slot	1

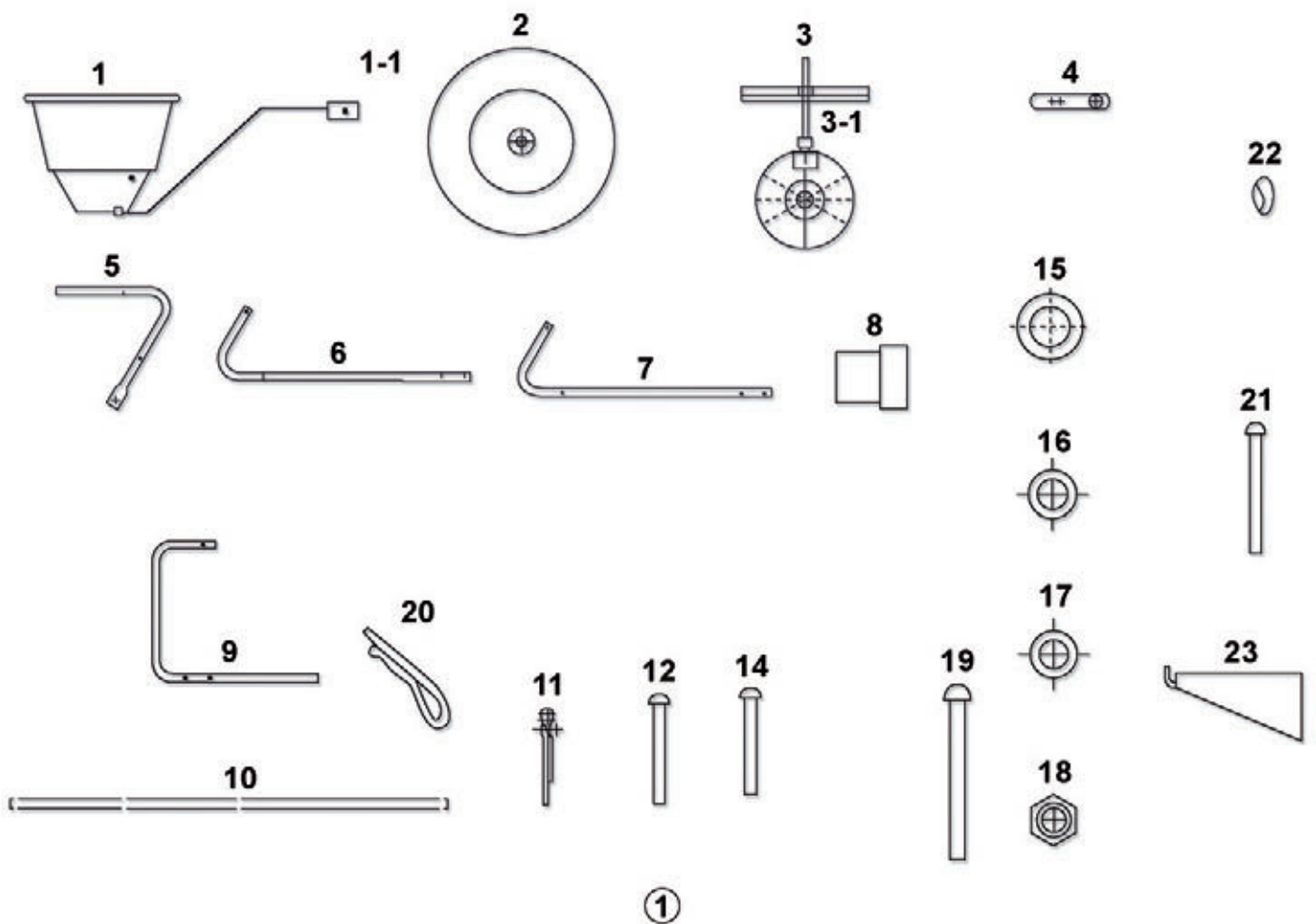

Parts and Hardware List

STEP 1

Gear Case and Axle Assembly

Part #	Description	Quantity
3-1	Gear Case Assembly	1
10	Axle	1
12	Screw M6x35	1
16	Small flat washer	1
16	Hex nut M6	1

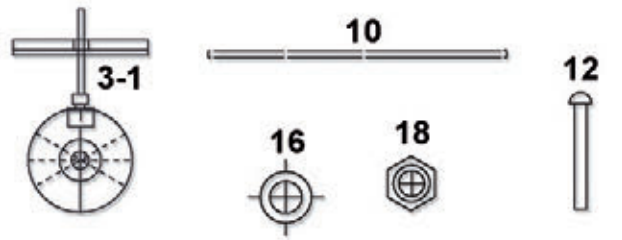

Slide axle (10) through gear case assembly (3-1) and secure using screw M6x35 (12), small flat washer (16) and hex nut (18). (Fig. 1)

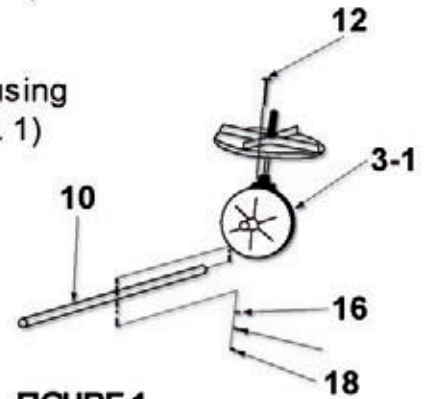
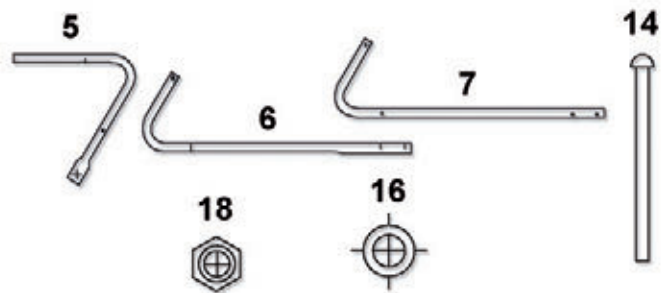

FIGURE 1

STEP 2

Axle and Frame Assembly

Part #	Description	Quantity
5	Back hopper support	2
6	Right hopper support	1
7	Left hopper support	1
14	Screw M6x50	4
16	Small flat washer	4
18	Hex nut M6	4



Attach back hopper supports (5) to right hopper support (6) and left hopper support (7) using screw M6x50 (14), small flat washer (16) and hex nut (18) as shown. Then slide back hopper support (5) onto axle (10). (Note: Split bushing (8) is factory installed on the back hopper supports.) (Fig.2)

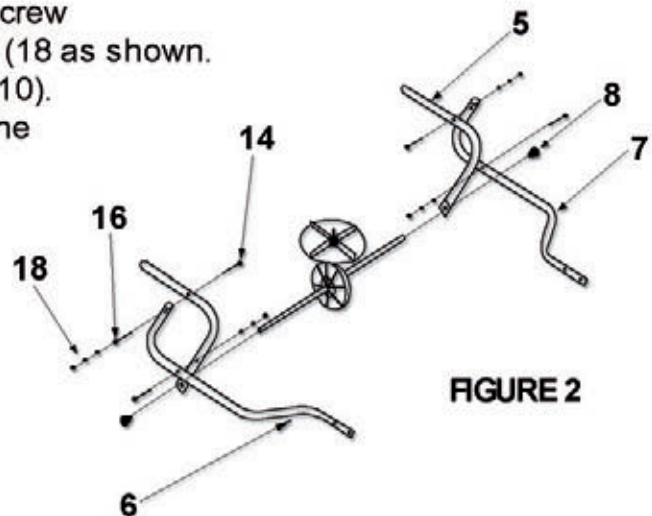

FIGURE 2

STEP 3

Part #	Description	Quantity
9	Front bracket	1
21	Screw M6x40	2
16	Small flat washer	2
18	Hex nut M6	2

Attach front bracket (9) to right support (6) and left hopper support (7) using screw M6x40 (21), small flat washer (16), and hex nut M6 (18). (Fig. 3)

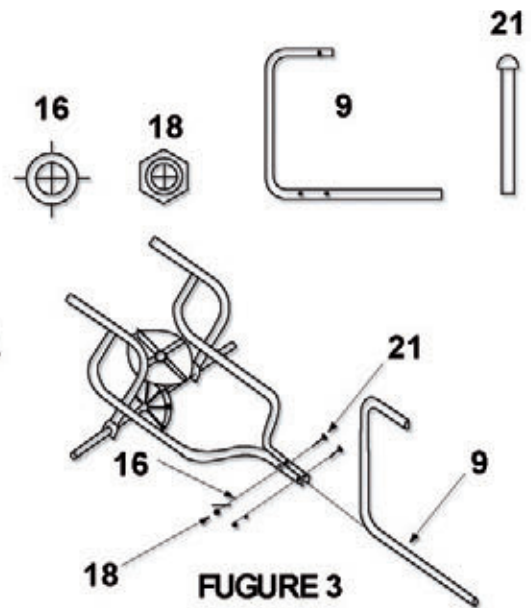

FIGURE 3

STEP 4

Part #	Description	Quantity
2	Wheel	2
15	Large flat washer	1
11	Cotter pin	1
14	Screw M6x50	1
16	Small flat washer	1
18	Hex nut M6	1

Slide a wheel (2) over left side of axle (10), followed by a large flat washer (15). Insert cotter pin (11). Place other wheel (2) on the right side of the axle (10) and secure using screw M6x50 (14), small flat washer (16) and hex nut (18). (Fig. 4)

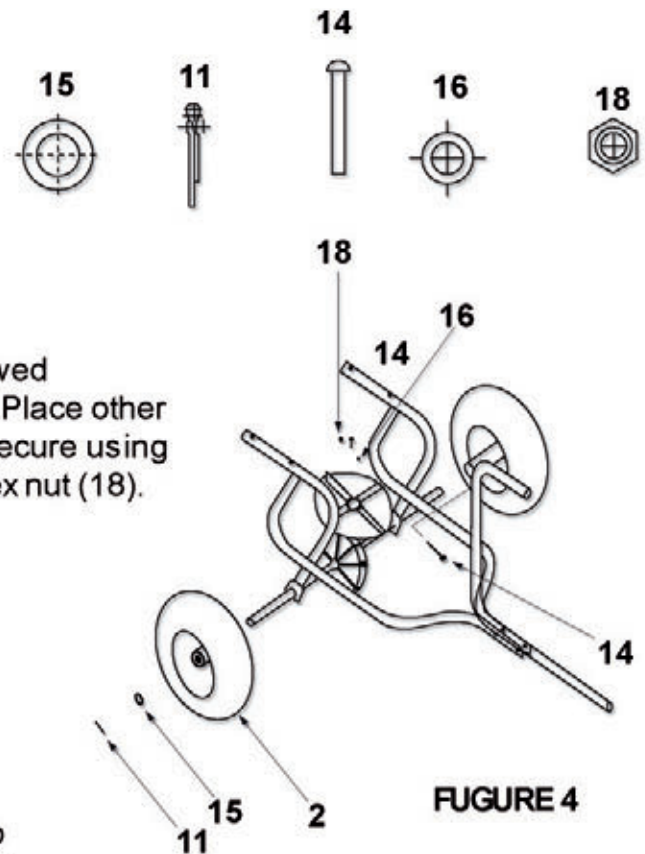
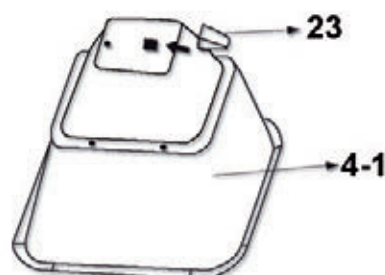
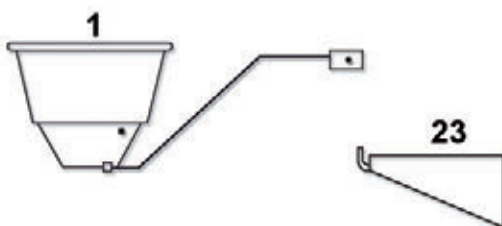

FIGURE 4

STEP 4-1

Part #	Description	Quantity
1	Tray	1
23	Slot	1

Turn the tray (1) upside down, slide slot (23) into the lead channel on the bottom of tray completely. (Fig. 4-1.)



STEP 5

Assembly Parts List

Part #	Description	Quantity
1	Hopper	1
21	Screw M6x40	4
16	Small flat washer	5
18	Hex nut M6	5
3	Spinner disc	1
20	Release pin	1
19	Screw M6x55	1
17	Lock washer	2

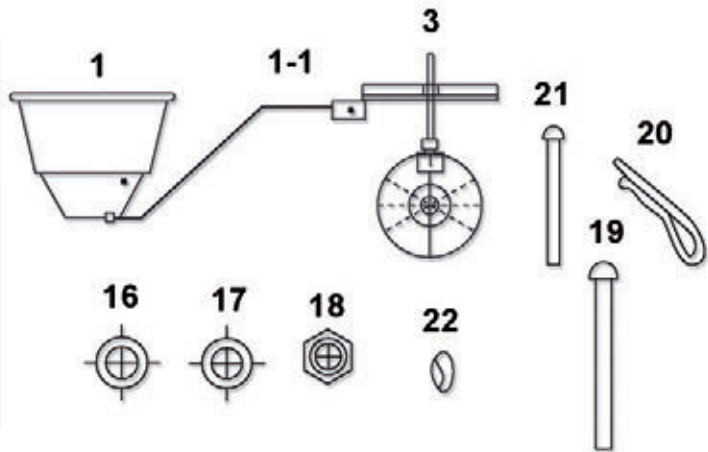

Attach hopper (1) to supports (5,6,7) using screw M6x40 (21), small flat washer (16) and hex nut (18). Attach hopper to spinner disc (3) using release pin (20).

Attach the control cable (1-1) to front bracket (9) with screw M6x55 (19), small flat washer (16), lock washer (17) and cable lock nut (22). (Note: Control cable (1-1) is factory installed onto hopper) (Fig. 5)

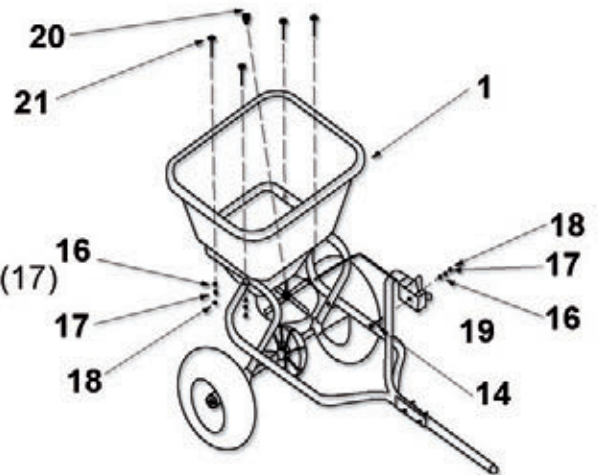

STEP 6

Assembly Parts List

Part #	Description	Quantity
2	Steering link connector	2
15	Screw M6x40	2
11	Small flat washer	2
14	Screw M6x50	2
16	Hex nut M6	2

Attach steering link connector (4) to front bracket (9) using screw M6x40 (21), small flat washer (16) and hex nut (18). (Fig. 6)

